

4

3

2

1

PATRIOT FULLY FRAMED GEAR LOCKER

ALUMINUM NUMBER PLATE
(FIELD INSTALL)

TWO COAT ROD HOOKS
COAT ROD, TWO
REAR COAT HOOKS

RECESSED POCKET WITH ADA
COMPLIANT ULTRA CREMONE LIFT
HANDLE WITH PADLOCK EYE

LOCK HOLE COVER PLATE
(FIELD INSTALL)

18GA. SOLID BACK

16GA. FRAME ASSEMBLY

14GA DIAMOND DOOR

CONTINUOUS HINGE

FULL FRAME CONSTRUCTION
8 INTEGRAL CAST CORNER PIECES

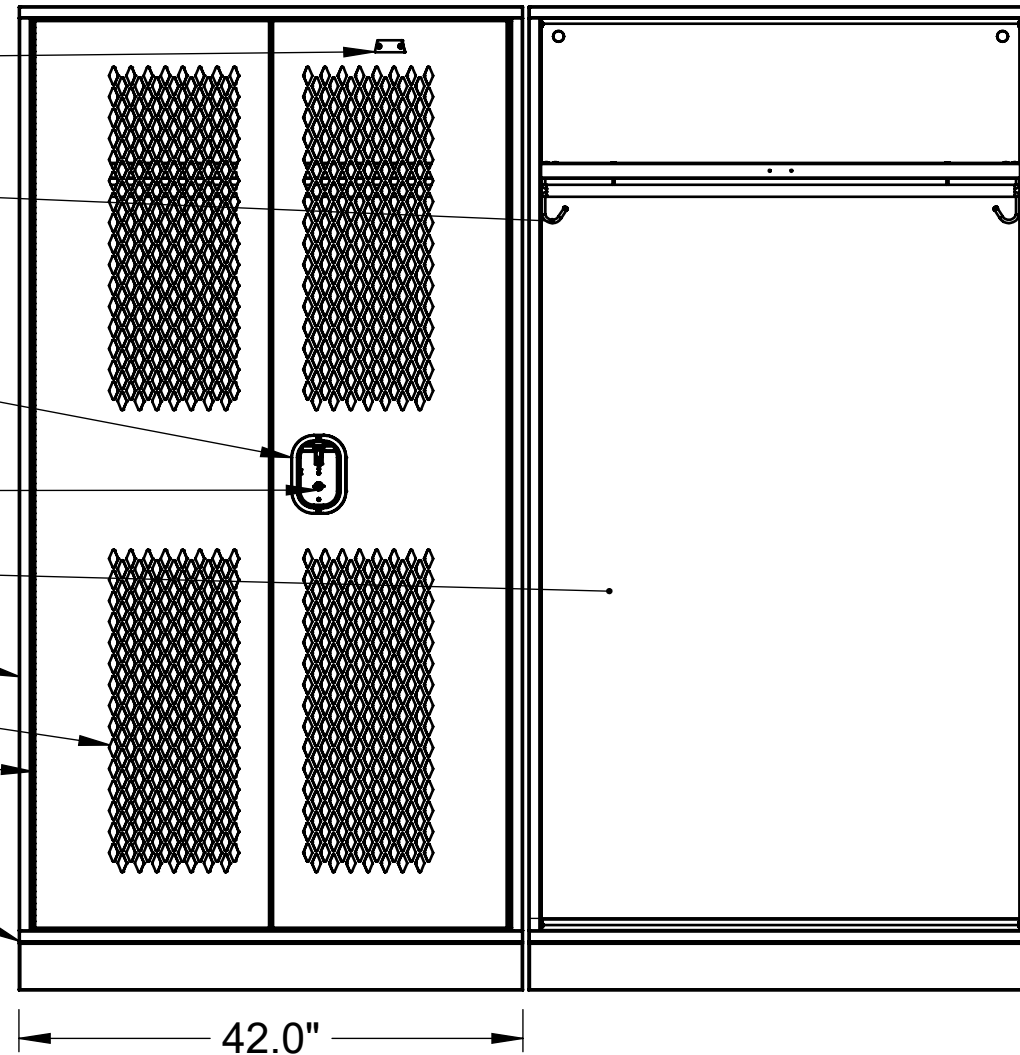

42.0"

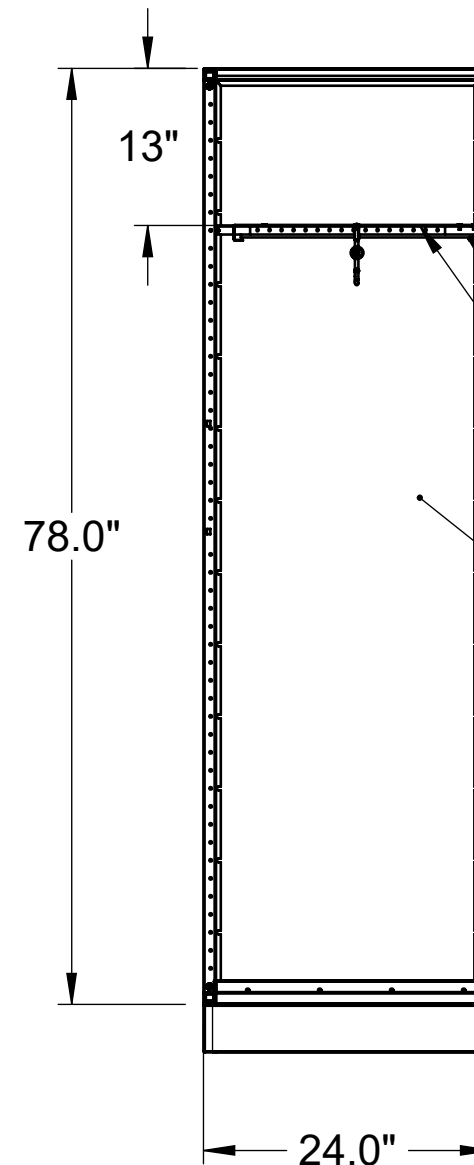

78.0"

24.0"

13"

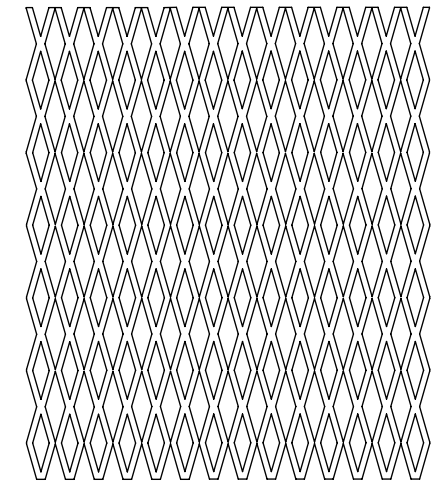

#13 FLAT. EXP. METAL

ANCHOR LOCKERS TIGHT
TO WALL @ 36" O.C.
(ANCHORS BY OTHERS)

16GA TOP, BOTTOM, &
INTERMEDIATE SHELF

#13 FLAT. EXP. SIDES
SOLID 16GA OPTIONAL

ANCHOR LOCKERS TIGHT
TO BASE / FLOOR @ 36" O.C.
(ANCHORS BY OTHERS)

SHOWN WITH OPTIONAL
4" CHANNEL BASE

AVAILABLE AS WELDED OR KNOCK DOWN

AVAILABLE WIDTHS 18, 24, 30, 36, 42, 48

AVAILABLE DEPTHS 18 DEEP ONLY ON 18 & 24 WIDE, 24 DEEP

AVAILABLE HEIGHTS 72, 78

SINGLE DOOR ONLY ON 18 WIDE AND BOTH SINGLE AND DOUBLE DOOR ON 24 WIDE

AVAILABLE DOOR PERFORATIONS SOLID, LOUVER, & DIAMOND

AVAILABLE SIDE PERFORATIONS SOLID, FLAT. EXP. METAL

AVAILABLE BASE OPTIONS NO BASE, 4 OR 6 INCH CHANNEL BASE

AVAILABLE INTERIOR COMPONENTS

CELL TRAY, CENTER PARTITION, COAT ROD, DOCUMENT SLEEVE, DRAWERS,

FOOT LOCKER, HALF SHELF, INNER COMPARTMENT DOOR, METAL SEAT,

SECURITY BOX, SHELF, & WOODEN SEAT



PENCO PRODUCTS, INC.
1820 Stonehenge Dr. Greenville, NC

4

3

2

1

B

A